

# Warehouse / Distribution Facility

1003 Bellbrook Ave., Xenia, 45385



## Property Features

- Total Available: 211,900 SF
- Minimum divisible: 40,000 SF
- Warehouse: 176,740 SF
- Office: up to 35,160 SF
- Ceiling Height: 18' - 36'
- Docks: 16
- Electric: 480/277 3 Phase
- Secure Parking available for up to 190 trailers and 650 cars
- 150+ truck court



### For More Information Contact

**Dean Miller**

513-383-8351 | [dmiller@icpllc.com](mailto:dmiller@icpllc.com)

**Kohl Kirkland**

937-489-0135 | [kkirkland@icpllc.com](mailto:kkirkland@icpllc.com)

This information has been secured from sources we believe to be reliable, but we make no representations or warranties, expressed or implied, as to the accuracy of the information. References to condition, square footage or age are approximate. Buyer or Tenant acknowledges that they are relying on their own investigations and are not relying on Broker provided information.



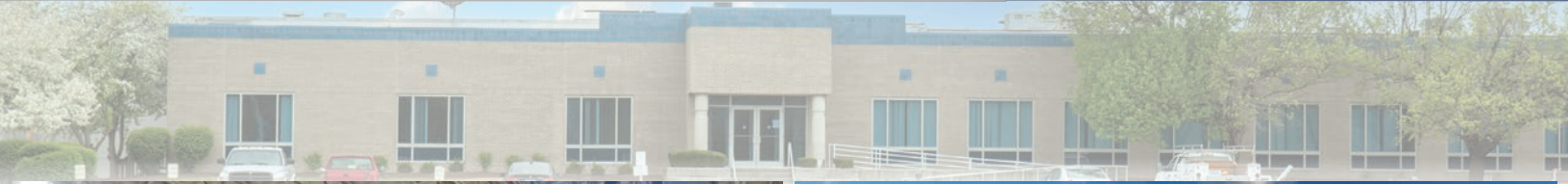

 **Industrial**<sup>TM</sup>  
COMMERCIAL PROPERTIES  
*Transforming the shape of business.*

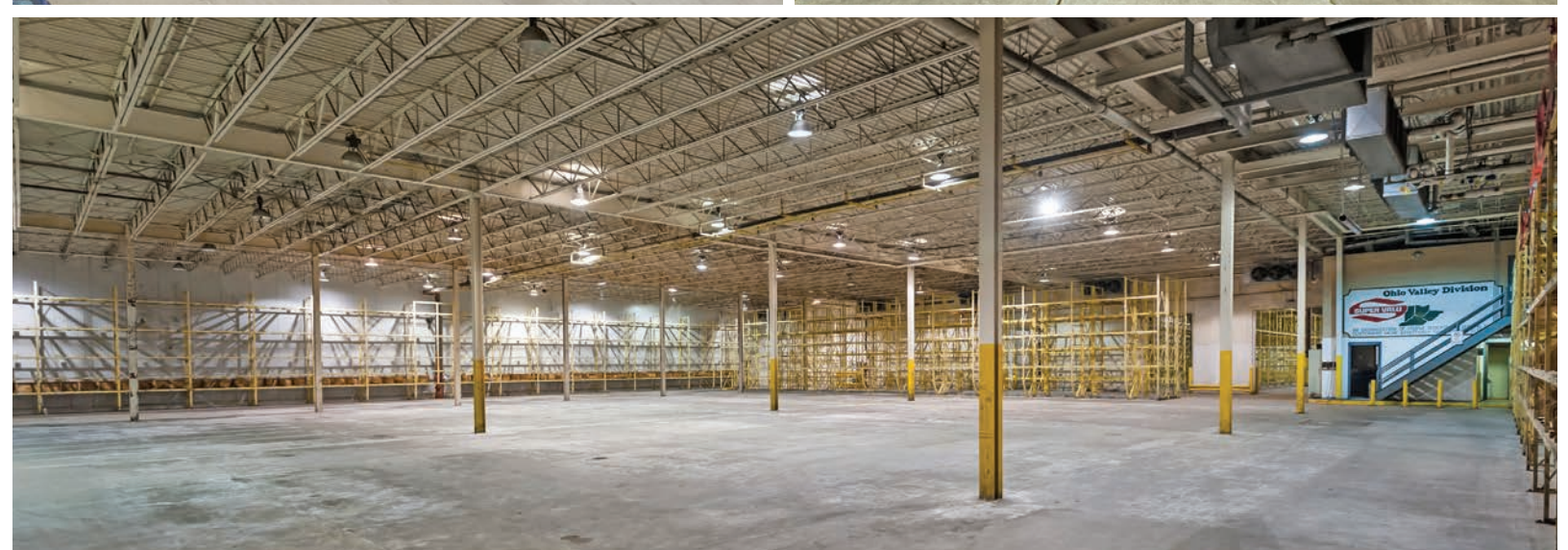

**For More Information Contact**  
**Dean Miller**  
513-383-8351 | [dmiller@icpllc.com](mailto:dmiller@icpllc.com)

**Kohl Kirkland**  
937-489-0135 | [kkirkland@icpllc.com](mailto:kkirkland@icpllc.com)



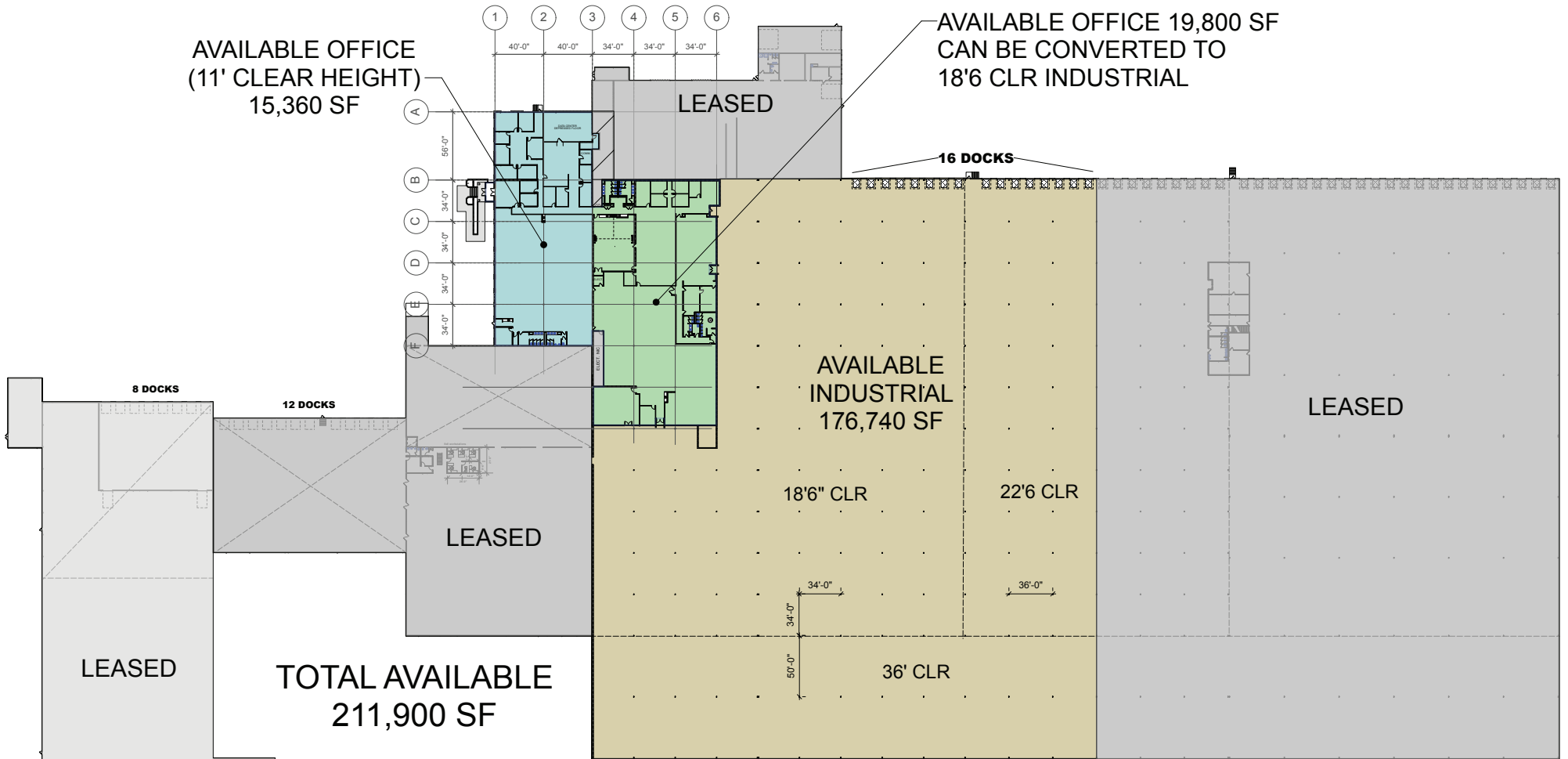

**TOTAL AVAILABLE  
211,900 SF**



For More Information Contact  
**Dean Miller**  
513-383-8351 | dmiller@icpllc.com

**Kohl Kirkland**  
937-489-0135 | kkirkland@icpllc.com

